

**Alarm**  
**Wireless Home Security**

**AGSHome**

# User's Manual



**V4**



# Contents

Introduction .....	1
Before you start .....	3
1. Quick Setup Guide .....	4
2. Connect your alarm system to smartphone .....	7
3. Learn to use Alarm System .....	9
4. Voice Control work with Alexa, and Google Home .....	14
5. How to use SET button of the Base Station .....	17
6. How to add additional Sensors and Key Fob .....	18

# Say hello to AGSHome Alarm.



## Alarm Base Station

The central hub of your Alarm system. Connects all of your Alarm devices to the Smart Life app, so you'll always stay in control of your home, wherever you are.

Connects to power with the included power supply.



## Contact Sensor

Alerts you when a door or window is opened.

Uses the Sensor magnet and mounting hardware included with the Contact Sensor Install Kit.



## Key Fob

Gives you hands-on control of your Alarm system.

Press the buttons to set the Alarm in 3 different Security Modes.

# BEFORE YOU START



## Wi-Fi Signal

The Alarm system is ONLY worked with a 2.4 GHz Wi-Fi signal, NOT a 5 GHz Wi-Fi signal.

### For 2.4 GHz Wi-Fi You'll need to know:

1. If you only have 5 GHz Wi-Fi router, you will **NOT** be able to complete the connection.
2. If you are using a dual Wi-Fi router and it broadcast 2 Wi-Fi signals, make sure that your phone was connected with the 2.4 GHz Wi-Fi signal, it should be the Wi-Fi signal that next to "\_5G".
3. If you are using a dual Wi-Fi router but it broadcast only 1 Wi-Fi signal, you will have to manage your Wi-Fi router and change the settings to have 2.4 GHz Wi-Fi.

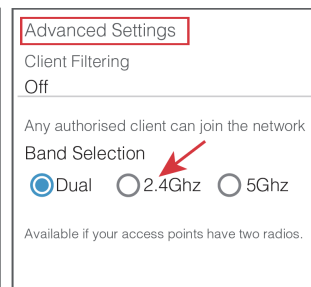
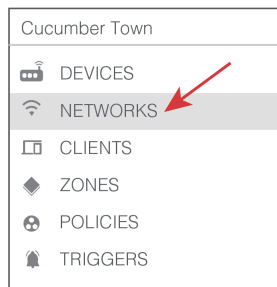
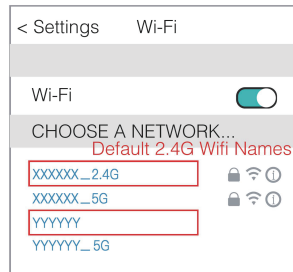

# 1. Quick Setup Guide

## 1) Power up the Base Station

The **Base Station** is the brains and primary siren of your system. It communicates with all of your devices and sends us your alarm signals if you have activated alarm monitoring service.

- Place your **Base Station** in a **central location** in your house. **DO NOT** install it on the floor.
- The base station must always connects to power with the included power supply.
- Rechargeable 8-hour battery backup only as an emergency battery.



## 2) How to use the Key Fob

### Alarm Modes

Your Alarm system has three Security Modes to choose from: **Disarmed**, **Away**, and **Home**. You can switch between them using the Key Fob.

#### Disarmed Modes

No Sensors inside your home are armed. This is useful when you're at home and want the freedom to go in and out easily.

#### Away Modes

When you arm in Away Mode, by default all Sensors are armed. This Mode should be used when you go out and there's no one at home.

#### Home Modes

When you arm in Home Mode, only door and window Sensors are armed by default. This Mode should be used when someone wants to stay home and feel safe.



#### SOS button

Alarm features a SOS Alarm just in case an emergency occurs while you're at home. To trigger it, press the lightning button on the Key Fob.

# 3) Contact Sensor Installation

## Test and Install the Contact Sensor

1. Remove the battery activation strip.
2. **Test the alignment before you adhere each piece.** (The **convex triangular sides** of the sensor and magnet need to face each other. Fig.1) The blue light should flash once when you separating the sensor and magnet.
3. Set your Alarm System to "Away Mode", the base station should sound sirens when you separating the sensor and magnet.
4. Adhere the sensor on the door and the magnet on the doorframe, or the other way around.

Fig. 1

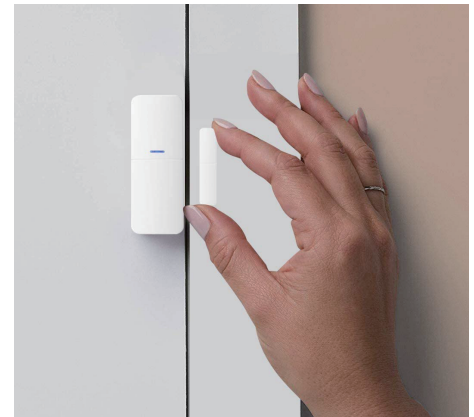
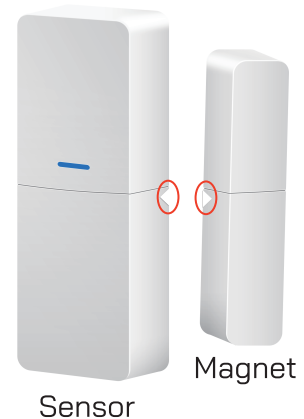

## 2. Connect your alarm system to smartphone

### 1. Set up your Smart Life account

1) First, download the Smart Life app for your iOS or Android device.

- Before setting up your Alarm, make sure you have the latest version of the Smart Life app from the app store.



2) Next, create your account.

- If you're new to Smart Life, tap **Sign up** to create account. Enter your mobile phone or email address, then tap **Get Verification Code**, enter the code you receive in your mobile phone or email to set up the password.
- If you already have a Smart Life account used for other devices, tap **Log in with Existing Account**.

## 2. Connect the Alarm Base Station to Smart Life app

**IMPORTANT:** Make sure your smartphone is connected to your home 2.4Ghz Wi-Fi signal before the following setup. Turn on your smartphone's **Bluetooth**.

1. Launch the app and tap the Plus ( + ) in the top right corner to add a device.
2. Tap **Go to add**.
3. Enter your home Wi-Fi name and password, then tap **Confirm**.
4. Now your Base Station is successfully added to Smart Life app. Tab **Done**.

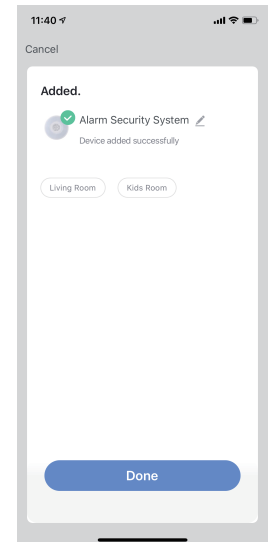
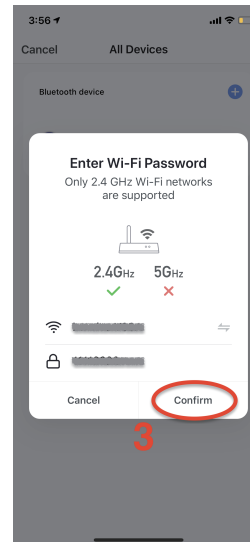
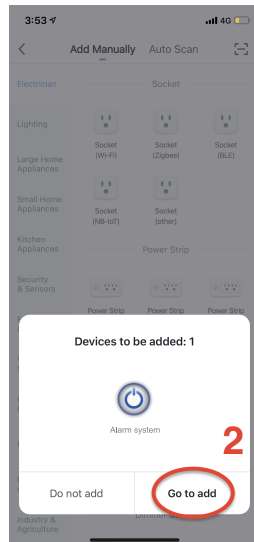
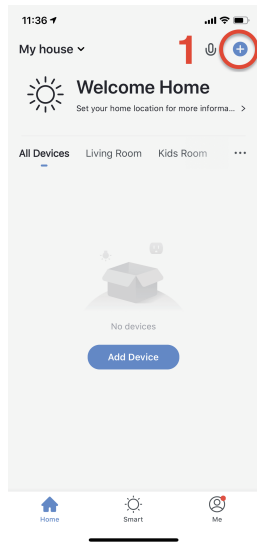

# 3. Learn to use Alarm System

## Alarm Modes

Your Alarm system has three Security Modes to choose from: **Disarmed**, **Away**, and **Home**. You can switch between them using the Key Fob and the Smart Life app.

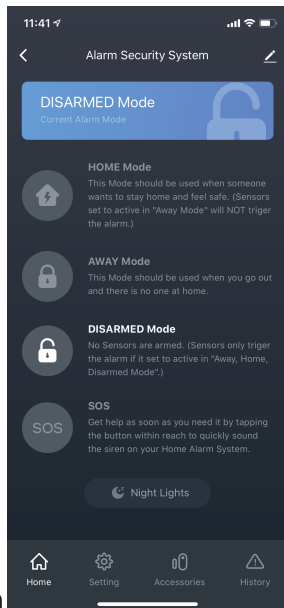

### Away Modes

When you arm in Away Mode, by default all Sensors are armed. This Mode should be used when you go out and there's no one at home.



### Home Modes

When you arm in Home Mode, only door and window Sensors are armed by default. This Mode should be used when someone wants to stay home and feel safe.



### Disarmed Modes

No Sensors inside your home are armed. This is useful when you're at home and want the freedom to go in and out easily.



# How to Arm and Disarm your Alarm

Using the **Key Fob**, simply press the Disarmed, Away, or Home Mode button.

Using the **Smart Life app**, simply tap the Mode of your choice.

- **Disarming will cancel your alarm signal.**

If you're professionally monitored, disarming the system during an alarm cancels the alarm signal sent to the monitoring center. In an emergency, allow the alarm to continue without disarming until you're sure response is not needed.

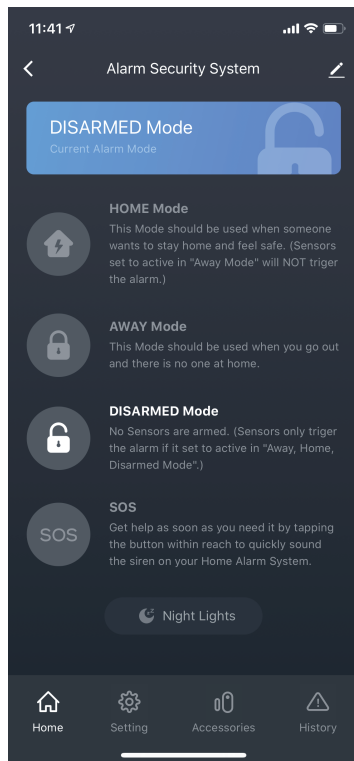

# \* Security Mode of Sensors

## Choosing which Sensors are monitored in each mode.

Each Security Mode monitors specific groups of Sensors.

By default, **Away Mode** and **Home Mode** arms only Contact Sensors used on doors and windows.

You can customize which Sensors are armed in **Away Mode**. For example, if you want to avoid arming a specific door while in Home Mode, you can adjust this using Mode Settings (choose trigger the Alarm in the **Away Mode**).

**\*\*Sensors set to **Away, Home, Disarmed Mode** will trigger the alarm even your alarm system is set to **Disarmed mode**.**

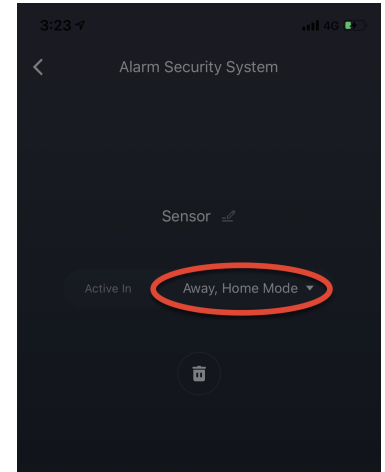

Trigger the Alarm in the

Away, Home, Disarmed

Away, Home Mode



Away Mode

Cancel

OK

# Understanding Entry & Exit Delay

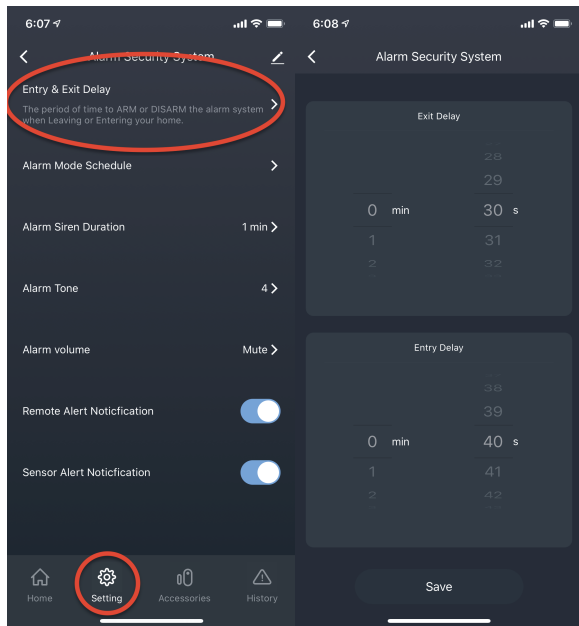

**Exit Delay** gives you a short period of time to leave your home once you've armed the Alarm. You'll hear a beeping sound to remind you that there is only a few seconds to exit your home and close the door. When your Exit Delay ends, your Alarm is in Armed Mode.

**Entry Delay** gives you a short time to disarm your Alarm when entering your home. Opening your door will trigger the Entry Delay to begin counting down. You'll hear beeping sound during the delay, and when the delay ends, if you don't disarm, your Alarm siren will sound.

\* Customize each delay for any time between 0 seconds (no delay) and 540 seconds (9 minutes). Just make sure you have enough time to arm and disarm your Alarm.

# Adding Shared Family Users

Tap **pen icon**, tap **Share Device**, then tap **Add Sharing** to enter sharing user's Smart Life account name.

*(Sharing users should sign up for a Smart Life account in advance.)*

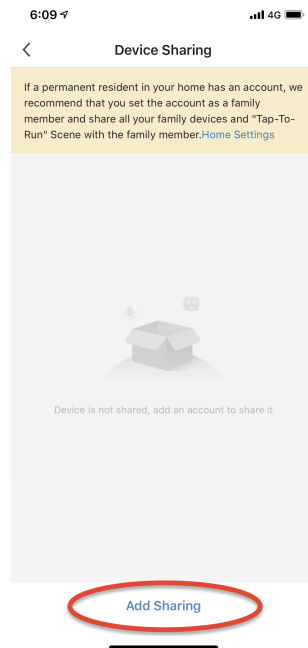
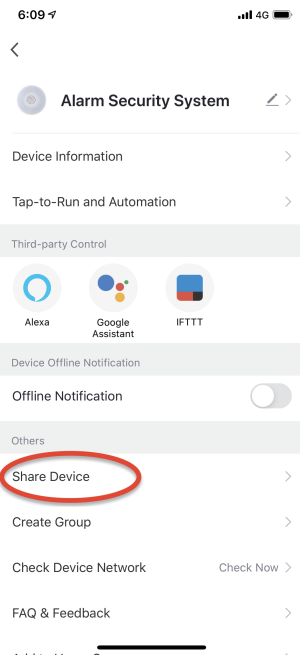
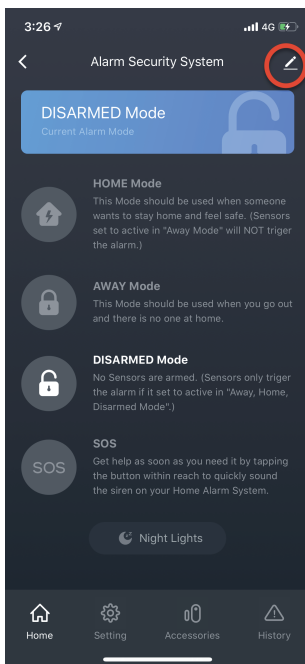

# 4. Work with Alexa, and Google Home

## Voice Control

Connect Alarm System to select Alexa, or Google Home devices to easily set your Alarm in **Home, Away, and Disarmed Modes** and check the status of your security system with hands-free voice control.

- Tap **pen icon**, then tap **Alexa** or **Google Assistant icon** to connect.

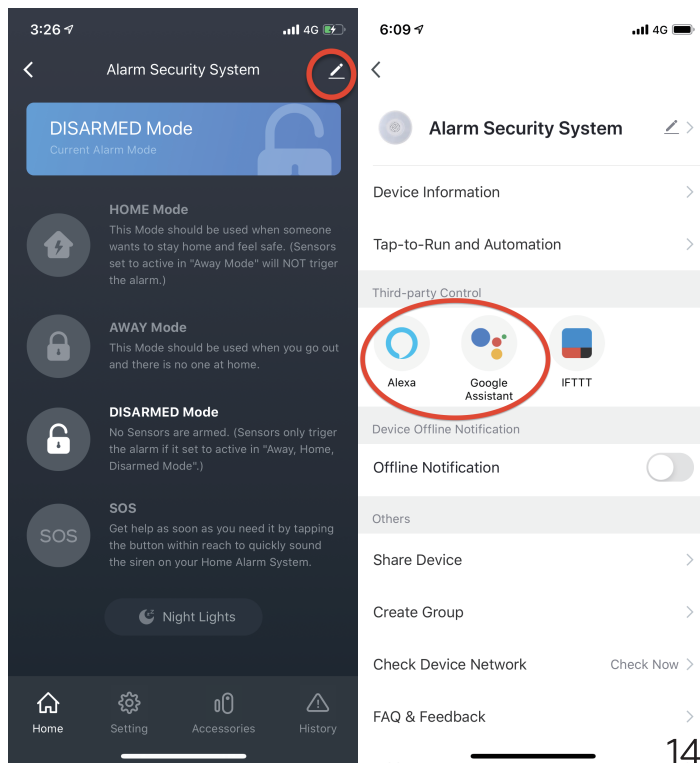

# Alexa Voice Commands

You can start controlling the Smart Alarm System with amazon Alexa using voice command.  
Such as:

- **"Alexa, arm {Alarm Security System} in away mode"**
- **"Alexa, arm {Alarm Security System} in home mode"**
- **"Alexa, disarm {Alarm Security System} "**
- **"Alexa, what's your voice code for my {Alarm Security System} ;  
Voice code 1234"**
- **"Alarmed" or "Disarmed"**

*\* {Alarm Security System} is the default name of your alarm system.*

# Google Home Voice Commands

You can start controlling the Smart Alarm System with Google Home device using voice command. Such as:

- **" Set the {Alarm Security System} to away mode."**
- **" Set the {Alarm Security System} to home mode."**
- **"Disarm {Alarm Security System} "**

*\* {Alarm Security System} is the default name of your alarm system.*

# 5. How to use SET button of the Base Station

## How to use SET button to RESET the base station

### RESET the base station

1. Turn **OFF** the base station.
2. Press and hold the **SET** button, and turn **ON** the base station while pressing the SET button.
3. You will hear 2 beeping sounds. Now the Base Station has been **RESET**.

\* This RESET procedure includes deleting all sensors and remote controls from the Base Station, and clear the Wi-Fi setting.



## 6. How to add additional Sensors and Key Fob Devices through the Smart Life APP

Setting up your Alarm security devices involves two steps:



1

### **Connect**

the device to your  
Alarm System.



2

### **Configure**

any unique settings  
as needed.

For the easiest setup, complete two steps for each device before moving on to the next one. Using the app and this guide, we'll help you position your Alarm to improve the security of your home.

# Key Fob

## 1. Connect

To connect a Key Fob, tap **Accessories** at the bottom to set up the key fob.

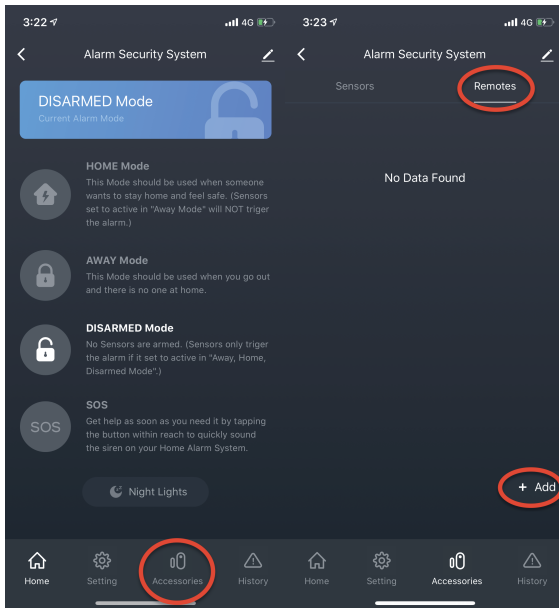

Tap **Remotes**, then **tap + Add**, then there will be followed by a beeping sound from the Base Station.

Now you need to press one of the key fob button.



# Key Fob

## 2. Configure

Using the app, choose the key fob, give it a unique name describing the key fob.

Tap **Remotes**, then tap **pen icon** to edit the device name.

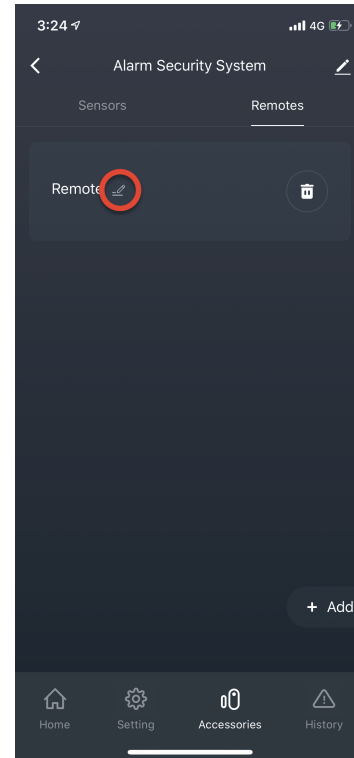

# Contact Sensor, Motion Sensor, & Door Bell

## 1. Connect

To connect a Contact Sensor, Motion Sensor or Door Bell, tap **Accessories** at the bottom to set up the sensor device.

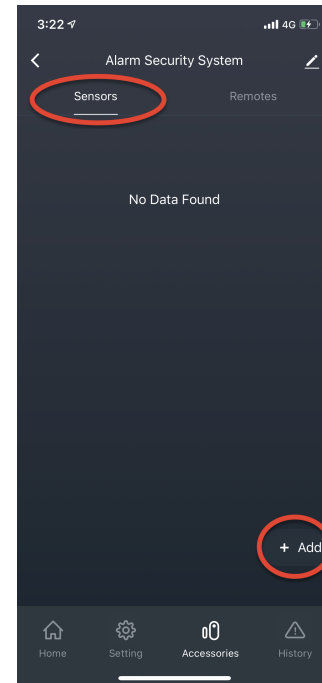
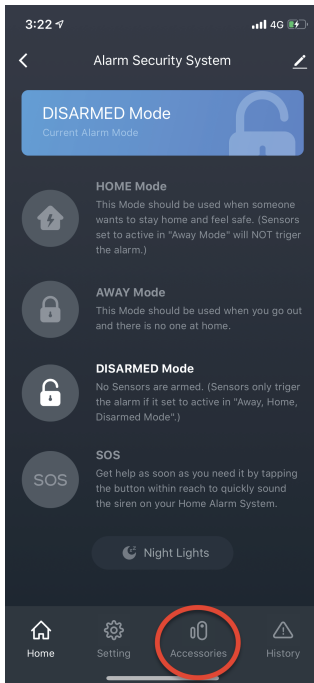

## a) Contact Sensor

Line up the Contact Sensor (sensor and magnet) together (Fig.1).

Tap **Sensors**, then tap **+ Add**, then there will be followed by a beeping sound from the Base Station. Now you need to separate the Contact Sensor (Fig.2).



Fig. 1

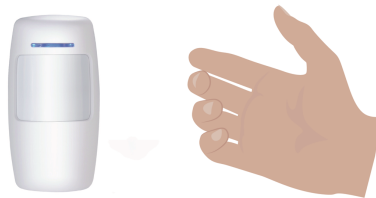

Fig. 2

## b) Motion Sensor

Turn on the **Motion Sensor** (ON/OFF button on the back).

Tap **Sensors**, then tap **+ Add**, then there will be followed by a beeping sound from the Base Station. Now you need to wave your hand in front of the Motion Sensor.



## c) Door Bell

Tap **Sensors**, then tap **+ Add**, then there will be followed by a beeping sound from the Base Station. Now press the Doorbell button.



## 2. Configure

Using the app, choose the Sensor placement (Door, Window or any name), give it a unique name describing the location, and assign it to a room.

Tap **Sensor**, then tap **pen icon** to edit the device name.

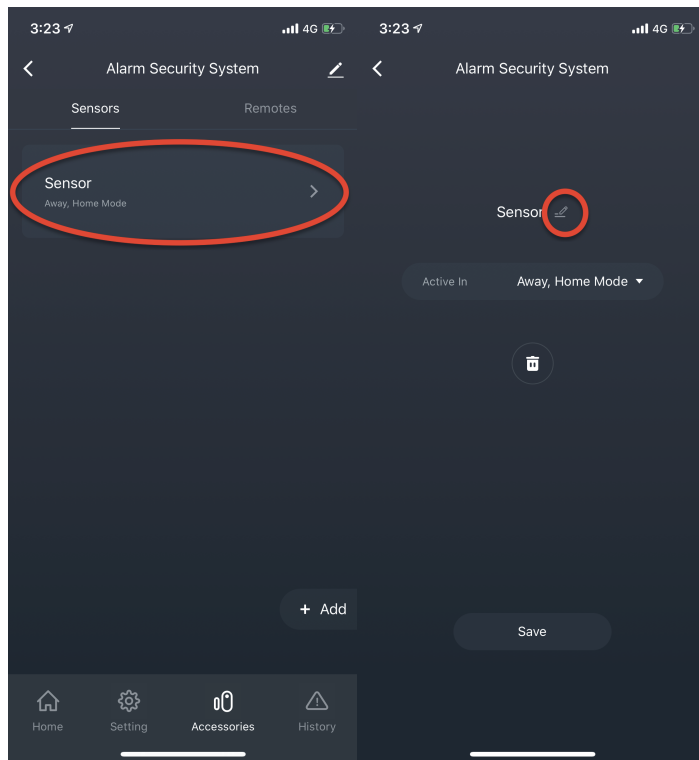



# AGSHome

Customize your safer home.



Keypad



Key Fob



Doorbell



Motion Detector



Contact Sensor



Alarm Horn Siren



Camera



Water Leak Detector